

Pump End Parts For Close-Coupled or Frame Mounted Configuration

For: M-Group power frame individual parts
see M-Group Power Frame repair parts page

Page 1 of 3 (Front)

MODEL

SST M-Group

Effective August, 1992

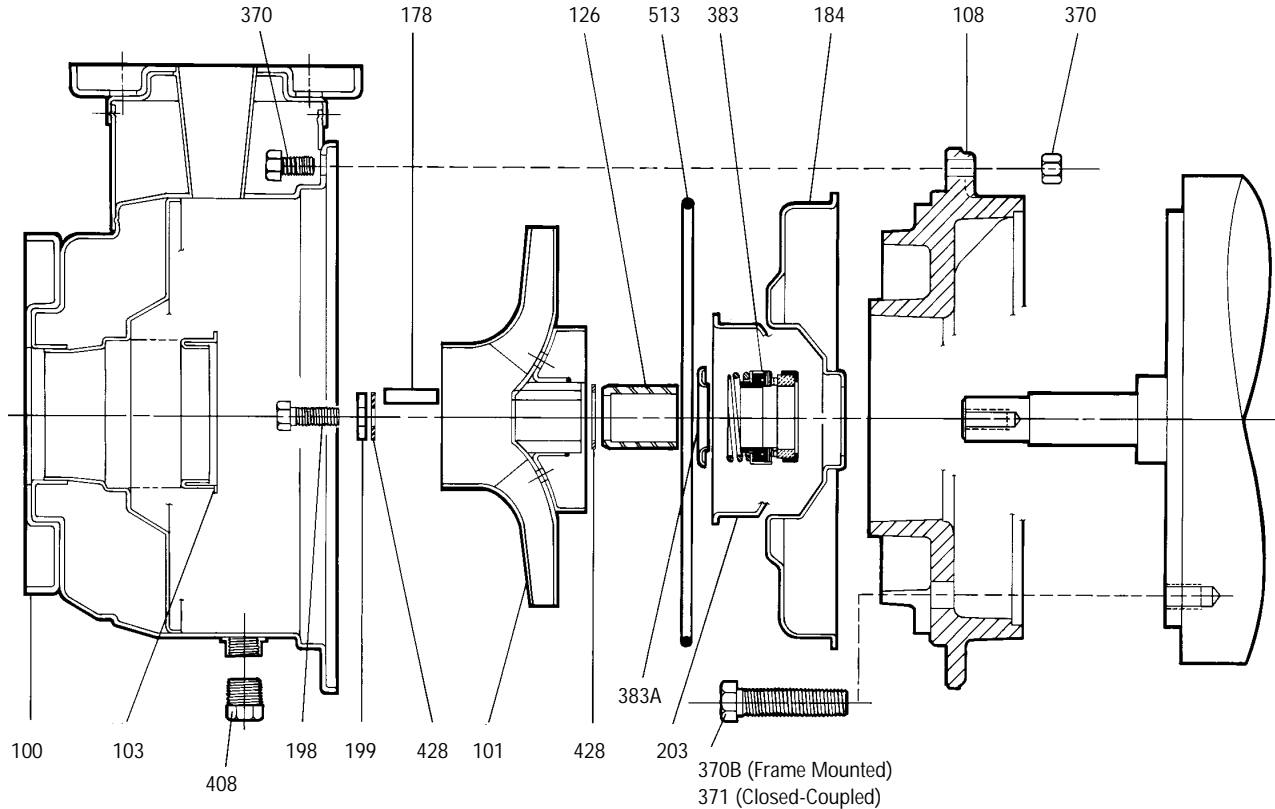

Note: For Pump End Parts for Close-Coupled with (140JM, 180JM, 210JM) see sheet (2 of 3).
For Pump End Parts for Close-Coupled with (250JM-360TCZ) and all Frame Mounted Configuration see sheet (3 of 3).

FASTENER SIZING KEY - (NOMINAL SIZE /TYPE/LENGTH)

13L40	1/2" Hex Head x 2 1/4" lg.
13L43	3/8" Hex Head x 2 1/4" lg.
13L86	1/2" Hex Head x 1 1/4" lg. with 1/2" Nut
13L87	5/8" Stud x 1 7/8" lg. with 5/8" Nut
13L88	1/2" Hex Head x 3 1/4" lg.
13L89	3/8" Hex Head x 1 1/4" lg. with 3/8" Nut
13K213	1/2" Hex Head x 3" lg.

Pump End Parts For Close-Coupled With (140JM, 180JM, 210JM)

Page 2 of 3 (Back)

Repair Parts

MODEL

SST M-Group

Effective August, 1992

Item No.	Description	Material	8" Impeller Models			10" Impeller Models				Max. Wt. lbs.
			2 x 2 1/2-8	2 1/2 x 3-8	3 x 4-8	1 1/4 x 2-10	1 1/2 x 2 1/2-10	2 x 2 1/2-10	2 1/2 x 3-10	
			Part No.	Part No.	Part No.	Part No.	Part No.	Part No.	Part No.	
100	Casing with Wear Ring		1L109			1L101	1L102	1L103		17
101	Impeller	AISI Type 304 S.S.	8 5/8 2L621 8 7/16 2L622 7 7/8 2L623 7 1/2 2L625 6 11/16 2L652 6 1/2 2L653	NA		10 1/16 2L431 9 13/16 2L432 8 7/8 2L433 8 5/8 2L434 7 7/8 2L435 7 3/4 2L421	10 1/16 2L531 9 5/8 2L532 9 7/16 2L533 8 7/8 2L534 8 1/16 2L535 7 3/4 2L521	10 1/16 2L631 9 13/16 2L632 9 7/16 2L633 9 1/16 2L634 8 7/16 2L622 8 1/16 2L624	NA	8
103	Wear Ring, Casing		4L103			4L101	4L102	4L103		—
184	Seal Housing		1L112			1L115				3
203	Wear Ring, Seal Hsg.		4L201			4L201				—
126	Shaft Sleeve					4K66				—
178	Impeller Key					4K11				—
198	Impeller Bolt					13K43				—
199	Impeller Washer					13L39				—
108	Adapter for Close-Coupled (140JM-180JM)	Cast Iron ASTM A48 CL 20	1L99	NA		1L97		NA	25	
	Adapter for Close-Coupled (210JM Motors)		1L98			1L96			29	
370	Casing Bolting Hex Bolt & Nut	AISI Type 300 S.S.	13L89			13L86			—	
371	Adapter Bolting Adapter to Motor (140JM-180JM)	Carbon St SAE 1200 Series	13L43	NA		13L43		NA	—	
	Adapter Bolting Adapter to Motor (210JM Motors)					13L40			—	
383	Mechanical Seal Standard Duty	Carbon/Ceramic				10K13			1/2	
	Mechanical Seal High Temperature	Carbon/Ni Resist				10K19				
	Mechanical Seal Chemical Duty	Carbon/Ceramic				10K25				
383A	Seal Spring Retainer	AISI Type 300 S.S.				4L45 (Replace with Mechanical Seal Assembly)			—	
408	Drain Plug 3/8 NPT					13L42			—	
428	Impeller Gasket Set	Cellulose Triacetate				5L73			—	
513	O-Ring-Casing	Buna-N	5L68			5L69			—	
	O-Ring-Casing (Optional)	Viton	5L70			5L71			—	

Note: For Pricing refer to published Parts Price List using "L" or "K" number above.

Pump End Parts For Close-Coupled With (250JM-360TCZ) And All Frame Mounted Configuration

For: M-Group power frame individual parts
see M-Group Power Frame repair parts page.

Repair Parts

MODEL

SST M-Group

Effective August, 1992

Item No.	Description	Material	8" Impeller Models			10" Impeller Models					Max. Wt. lbs.	
			2 x 2 1/2-8	2 1/2 x 3-8	3 x 4-8	1 1/4 x 2-10	1 1/2 x 2 1/2-10	2 x 2 1/2-10	2 1/2 x 3-10	3 x 4-10		
			Part No.	Part No.	Part No.	Part No.	Part No.	Part No.	Part No.	Part No.		Part No.
100	Casing with Wear Ring		1L109			1L101	1L102	1L103				17
101	Impeller	AISI Type 304 S.S.	8 5/8 2L321 8 7/16 2L323 8 1/4 2L324 7 7/8 2L325 7 1/2 2L326 7 1/16 2L351 6 11/16 2L352 6 1/2 2L353	NA		9 13/16 2L132 9 1/4 2L133 8 7/8 2L134 8 5/8 2L135 8 1/4 2L136 7 7/8 2L137 7 3/4 2L138	9 5/8 2L232 9 7/16 2L233 8 7/8 2L234 8 7/16 2L235 8 1/16 2L236 7 3/4 2L237	9 7/16 2L333 9 1/16 2L334 8 7/8 2L335 8 5/8 2L321 8 7/16 2L323 8 1/16 2L322	NA			8
103	Wear Ring, Casing		4L103			4L101	4L102	4L103				—
184	Seal Housing		1L117				1L120					3
203	Wear Ring, Seal Hsg.		4L201				4L201					—
126	Shaft Sleeve					4K262						—
178	Impeller Key					4K261						—
198	Impeller Bolt					13K155						—
199	Impeller Washer					13L241						—
108	Adapter for Power Frame Close-Coupled (250JM Motors)	Cast Iron ASTM A48 CL 20	1L89	NA		1L91		NA				31
	Adapter for Close-Coupled (280JM-360TCZ)		1L88			1L90				44		
370	Casing Bolting Hex Bolt & Nut	AISI Type 300 S.S.	13L89			13L86						—
370B	Adapter Bolting Adapter to Bearing Frame	Carbon/Steel	13L88	NA		13L88		NA				—
371	Adapter Bolting Adapter to Motor (250JM Motors)		13L88			13L88				—		
	Adapter Bolting Adapter to Motor (280JM-360TCZ)					13L87				—		
383	Mechanical Seal Standard Duty	Carbon/Ceramic				10K16						1/2
	Mechanical Seal High Temperature	Carbon/Ni Resist				10K20						
	Mechanical Seal Chemical Duty	Carbon/Ceramic				10K26						
383A	Seal Spring Retainer	AISI Type 300 S.S.				4L216 (Replace with Mechanical Seal Assembly)						—
408	Drain Plug 3/8 NPT					13L42						—
428	Impeller Gasket Set	Cellulose Triacetate				5L74						—
513	O-Ring-Casing	Buna-N	5L68			5L69				4K244		—
	O-Ring-Casing (Optional)	Viton	5L70			5L71				5L72		—

Note: For Pricing refer to published Parts Price List using "L" or "K" number above.